

# McKissick® Sheaves



McKissick  
Sheaves

# McKissick<sup>®</sup> Roll Forged<sup>™</sup> Sheaves

## Stepped hub design proves better.

The McKissick hub is stepped to eliminate stress failure in the weld, common in traditional hub designs. The hub is pressed into place with complete metal-to-metal contact. This helps ensure an accurate alignment to the hub's axis so there's no wobble or lopping of the rotating sheave.

The precision aligned hub / sheave wheel combination adds to the bearing life and keeps the sheave on the job longer.

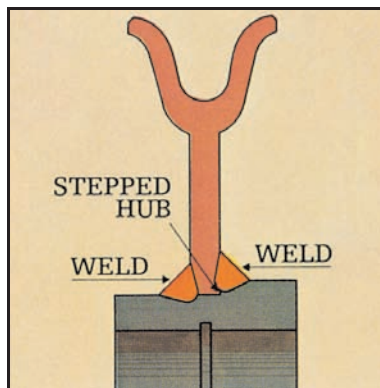

## Closed die upset and roll forged — not split.

Upsetting and roll forging forms the groove and flange walls in multiple steps, eliminating the need to split and weaken the groove. This exclusive forging process adds extra strength to the critical groove section. You can count on a McKissick sheave to give maximum life performance, because it's forged to distribute the wire rope forces evenly over an accurately formed load surface. Plus, uniformity of the roll forged groove adds longer wire rope life.

## Full range of standard sheave sizes.

McKissick roll forged sheaves are available in a full range of sizes from 12 inches to 72 inches, and bearing styles and prices that best fit your application. Crosby also manufactures custom McKissick sheaves and can make minor modifications to standard sheaves as needed for special applications.

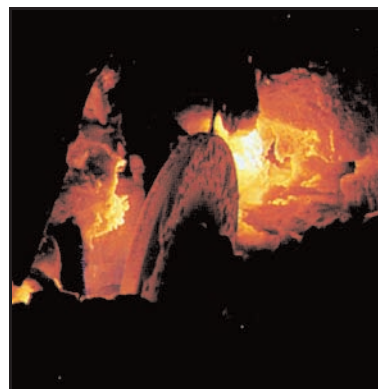
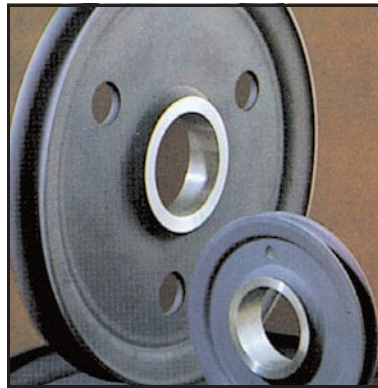

## Solid steel — no casting.

Every McKissick sheave starts as a single piece of solid carbon steel plate. It's flame-cut from closely checked stock, so there's no inherent web / rim flaw as you find in cast sheaves.

There's better balance and better distribution of forces with a McKissick roll forged sheave too. Casting can result in groove wall variations - either too thick or too thin - causing uneven stresses and early failure.

## Flame hardened groove.

Crosby's hardening technique is a science. It provides a precise maximum hardness for wear-resistance across the wire rope contact area. The McKissick sheave groove is flame hardened to a minimum 35 Rockwell C for a 140° contact area with the wire rope. The solid steel plate provides the ideal surface for flame hardening and a closer tolerance fit to the wire rope to reduce fatigue and wear.

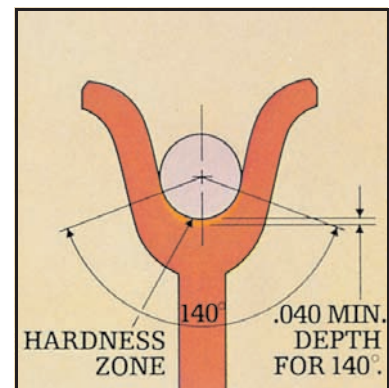

## Bearing selection to match your job requirement.

The McKissick Roll Forged sheave is available in the following configurations:

- Plain bore
- Bronze bushed
- Roller bearing
- Tapered roller bearing
- Lubrication thru hub
- Key ways
- Set screws

# Ordering Information

McKissick® sheaves come in a variety of sizes to suit your specific applications. Check the tables for the size, bearing style and price that best fits your application. For applications that require unique specifications, Crosby can make minor modifications to many of the sheaves listed at a reasonable charge. We can also custom design and manufacture sheaves to your exact requirements. Contact Crosby Sales to order McKissick® sheaves and include the stock number and quantity. For special requirements or custom designed sheaves, furnish the following important information:

- Wireline Size
- Shaft Diameter
- Weight Requirements
- Hub Diameter
- Bore Finished
- Nominal Outside Diameter
- Hub Width
- Rim Width
- Nominal Tread Diameter
- Other Special Requirements

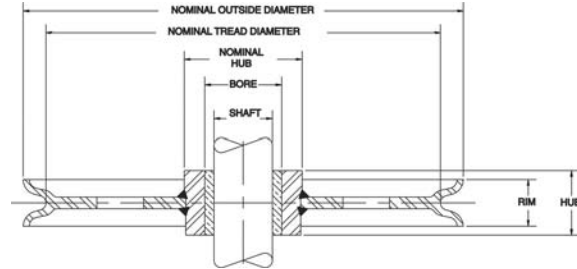

## ROLL FORGED™ SHEAVE FEATURES

- Unique upset roll forging process provides a thicker groove section for extra strength.
- Stepped Hubs are precisely centered and mechanically locked in place.
- Wireline grooves on sheave diameters of 356mm and larger are flamed hardened for extra wear resistance.
- All sheaves have solid steel webs with holes for easy handling.
- Sheave weights can be made heavier or lighter than shown to fit your specific application.
- For more information ask for our special brochure describing the complete roll forging process.

## McKISSICK® ROLL FORGED™ SHEAVE CONFIGURATOR

The McKissick® Roll Forged™ Sheave CONFIGURATOR system has been developed to simplify the selection and ordering of McKissick® Roll Forged™ sheaves. Although McKissick® can custom manufacture any Roll-Forged™ sheave to your exact requirement, we have developed a system to allow quick and easy selection of the proper standard McKissick® Roll Forged™ sheave required to meet your applications. Using standard sheaves will reduce the lead time in getting the sheave to you, thus saving time and money.

For more information, see page 242, or contact your local authorized Crosby distributor.

## SHEAVE BEARING APPLICATION INFORMATION

### Bronze Bushing -

Slow line speed, moderate load and moderate use,  
 Maximum Bearing Pressure (BP): 31N/mm<sup>2</sup>  
 Maximum Velocity at Bearing (BV): 366m/min  
 Maximum Pressure Velocity Factor (PV): 114

$$\text{Formula for BP} = \frac{\text{Line Pull} \times \text{Angle Factor (See Page 335)}}{\text{Shaft Size} \times \text{Hub Width (See example)}}$$

### Plain Bore -

Very slow line speed, very infrequent use, low load.

### Roller Bearing -

Faster line speeds, more frequent use, greater load.

### Example:

Using a 356mm sheave (917191) with a 20,000 N line pull and a 80 degree angle between lines, determine maximum allowable line speed.

$$\text{BP} = 20,000 \text{ N} \times 1.53 \div 38 \times 41 = 19,64 \text{ N/mm}^2$$

(Line Pull) (Angle Factor) (Shaft Size) (Hub Width)

$$\text{BV} = 114 \div 19,64 = 5,8 \text{ m/min}$$

(PV Factor) (BP)

# McKissick® Roll Forged Sheaves

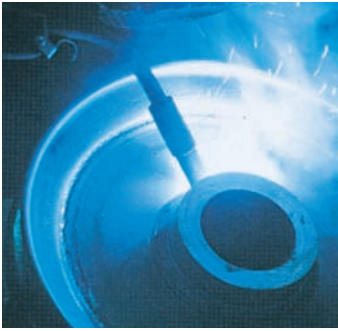

## What It Does For You

The McKissick® Roll Forged™ Sheave Configurator System has been developed to simplify the selection and ordering of McKissick® Roll Forged™ sheaves. Although McKissick® can custom manufacture any Roll Forged™ sheave to your exact requirements, we have developed the Configurator System to allow quick and easy selection of the proper standard McKissick® Roll Forged™ sheave required to meet your application. Using standard sheaves will reduce the lead time in getting the sheave to you, thus saving time and money.

For additional information on the McKissick® Roll-Forged™ Sheave Configurator system, contact your local authorized Crosby Dealer or Crosby Customer Service.

## USING THE CONFIGURATOR

Using the Configurator is as simple as following these 5 steps. The result is a sheave number representing the standard McKissick® Roll Forged™ sheave you desire.

**STEP**  
**1**

Determine the standard O.D. of the sheave you desire in the *Sheave O.D. / Wire Line Information Table*.

**STEP**  
**2**

Determine the Wire Line No. located in the *Sheave O.D. / Wire Line Information Table*.

24 | 14 | P | T | 10

**STEP**  
**3**

Determine if you want to receive the sheave with bearing assembled or simply machined for the bearing and / or thrust washer you provide.

**STEP**  
**4**

Determine the proper bearing or bushing you will require based on your application. (See Bearing Application Maintenance Summary Table - page 244.)

**STEP**  
**5**

Determine the proper Bearing No. for size bearing required. The hub of the sheave will be machined to those dimensions. Based on your answer to Step 3, we will either install the desired bearing into the sheave, or simply ship the sheave machined.

# McKissick<sup>®</sup> Roll Forged<sup>™</sup> Sheaves

## Selecting your Sheave O.D. / Wire line Size Combinations

To ease the effort in choosing the proper standard McKissick<sup>®</sup> Roll Forged<sup>™</sup> sheave required for your application, we have simplified our product offering. The table below indicates the standard "Sheave O.D. / Wire Line Size" combinations that are available.

### How to Read the Table

- The Wire Line No. corresponds to 1/16 of an inch (i.e. Wire Line No. 8 is 8/16, and represents a 1/2" wire line size).
- Cells outlined in **RED** represent the standard O.D. / Wire Line combinations available with the Sheave Configurator program.
- The Wire Line No. and Sheave O.D. information is color coded to correspond to the Sheave Configurator example found on Page 244.

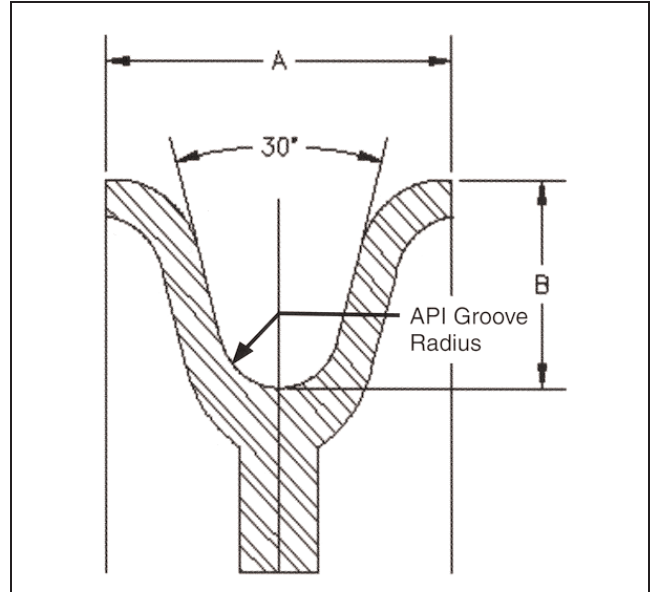

## SHEAVE O.D. / WIRE LINE INFORMATION

Wire Line No.	Wire Line Size (in.)	Nominal Dimensions (in.)		API Groove Radius (in.)		SHEAVE O.D. (in.)																							
		A	B	MIN	MAX	14	15	16	17	18	20	22	24	26	27	28	30	32	33	34	36	40	42	48	50	52	55	60	
08	1/2	1.25	0.75	0.265	0.275																								
09	9/16	1.41	0.84	0.298	0.309																								
10	5/8	1.56	0.94	0.331	0.344																								
12	3/4	1.75	1.13	0.398	0.413																								
14	7/8	2.00	1.31	0.464	0.481																								
16	1	2.25	1.50	0.530	0.550																								
18	1-1/8	2.50	1.69	0.596	0.619																								
20	1-1/4	3.00	1.88	0.663	0.688																								
22	1-3/8	3.25	2.06	0.729	0.756																								
24	1-1/2	3.50	2.25	0.795	0.825																								
26	1-5/8	3.50	2.44	0.861	0.894																								
28	1-3/4	3.75	2.63	0.928	0.963																								
30	1-7/8	3.75	2.81	0.994	1.031																								
32	2	4.25	3.00	1.060	1.100																								

For any other combinations, please contact our Special Engineered Products Dept at 800/777-1555

# McKissick<sup>®</sup> Roll Forged Sheaves<sup>™</sup>

## Bearing Selection

Selecting the proper bearing is critical to the performance of any application using McKissick<sup>®</sup> Roll Forged<sup>™</sup> sheaves. Sheave load, line speed, frequency of use and the operating environment are important considerations when making bearing selection.

For detail information, refer to the **Sheave Bearing Application Information** section of the *Tackle Block Warning, Use and Maintenance Information* in the latest Crosby General Catalog.

The table below gives general bearing selection criteria and maintenance information.

### BEARING APPLICATION/ MAINTENANCE SUMMARY

Bearing Type	Speed	Use	Load	Lubrication Schedule	
				Type of Operation	
				Continuous	Intermittent
<b>Anti-Friction</b>					
• Roller Bearing	Fast	Frequent	High	Every 24 Hours	Every 14 Days
• Tapered Roller Bearing	Fast	Frequent	High	Every 40 Hours	Every 30 Days
<b>Bronze Bushed</b>	Slow	Moderate	Moderate	Every 8 Hours	Every 14 Days

In addition, if you have further technical questions concerning bearing applications or selection, please contact us in Tulsa, Ok. at (918) 834-4611.

## Configurator Example

To order a sheave that has the following requirements:

- O.D.** — 24"
- Wire Line Size** — 7/8"
- Bearing** — 6.500"  
Tapered Roller Bearing to be furnished by customer

The *Configurator Code* would be: 2414PT10

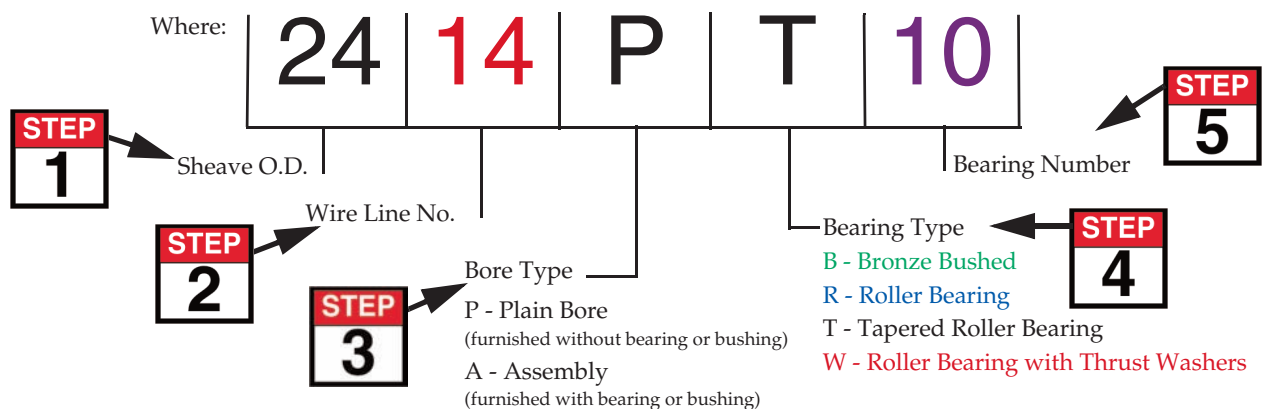

For additional information on the McKissick<sup>®</sup> Roll-Forged<sup>™</sup> Sheave Configurator system, contact your local authorized Crosby Dealer or Crosby Customer Service

### (B) BRONZE BUSHING (SAE 660 Bronze with Figure 8 Oil Groove)

Bronze Bushing No.	Stock No.	Dimensions			Minimum Sheave O.D. (in.)
		A	B	C	
01	5201	1.500	1.88	1.50	10
02	17243	1.500	1.88	1.75	10
03	8001002	1.750	1.88	1.50	10
04	32976	1.750	2.25	2.50	10
05	33626	2.000	2.50	1.50	10
06	17289	2.000	2.50	1.75	10
07	21229	2.000	2.50	1.97	10
08	50526	2.000	2.50	2.00	10
09	17298	2.000	2.50	2.31	10
10	33323	2.000	2.50	2.50	10
11	36231	2.250	2.75	2.31	10
12	17332	2.250	2.75	2.50	10
13	7959	2.500	3.00	1.75	10
14	17369	2.500	3.00	2.31	10
15	2004881	2.500	3.25	2.00	10
16	17387	2.756	3.25	2.31	10
17	17412	3.000	3.50	2.31	10
18	6184	3.000	3.50	3.00	10
19	2009578	3.000	3.75	2.50	12
20	1423329	3.250	4.00	2.50	12
21	17430	3.500	4.00	2.81	12
22	10446	3.500	4.00	3.00	12
23	23897	3.500	4.25	2.75	12
24	18395	3.750	4.25	2.50	12
25	23959	3.750	4.25	2.75	12
26	45604	3.940	4.50	3.00	12
27	17467	4.000	4.50	3.00	12
28	17476	4.000	4.50	3.50	12
29	8010186	4.250	4.75	2.00	12
30	138666	4.500	5.00	2.75	14
31	26714	4.500	5.00	3.50	14
32	31986	5.000	5.50	2.75	16
33	10776	5.000	5.50	3.50	16
34	1410681	5.750	6.50	3.38	16
35	1419940	6.000	7.00	4.12	18
36	2009999	7.000	8.00	5.00	20
37	2004306	8.000	9.00	2.75	22

# McKissick<sup>®</sup> Roll Forged<sup>™</sup> Sheaves

The McKissick<sup>®</sup> Roll Forged<sup>™</sup> Sheave Configurator makes it easy to select the proper bearing needed for your job requirement. Simply determine the style of bearing that best suits the type of operation the sheave will see (refer to Bearings Application/Maintenance Summary Table, previous page), then select the Bearing No. from the respective table below.

Roller Bearing No.	Stock No.	Dimensions			Description	Minimum Sheave O.D. (in.)
		A	B	C		
01	2003084	1.500	2.06	1.25	MR-24-SS	10
02	220834	1.750	2.31	1.25	HJ-283720	10
03	17935	2.000	2.56	1.25	MR-32-SRS	10
04	17948	2.250	3.00	1.25	HJ-364820	10
05	59368	2.250	3.00	1.50	HJ-364824	10
06	122165	2.250	1.75	1.75	MR-36	10
07	30086	2.500	3.25	1.75	MR-40-RSS	10
08	49496	2.500	3.25	1.75	HJ-405228	10
09	2002423	2.756	3.50	1.75	HJ-445628	10
10	220745	3.000	3.75	1.50	HJ-486024	12
11	137694	3.000	3.75	1.75	HJ-486028	12
12	2003198	3.000	3.75	1.75	MR-48-RSS	12
13	241465	3.250	4.25	1.75	HJ-526828	12
14	18080	3.250	4.25	2.00	HJ-526832	12
15	147647	3.500	4.50	2.00	HJ-567232	12
16	243347	4.750	4.75	2.00	HJ-607632	12
17	146327	4.000	5.00	2.00	HJ-648032	14
18	22020	4.250	5.25	2.00	HJ-688432	14
19	2003312	4.500	6.00	2.25	MR-72	16
20	17993	4.500	6.00	2.50	HJ-729640	16
21	2003825	5.000	6.50	2.25	HJ-8010436	16
22	2007615	5.000	6.50	2.50	HJ-8010440	16
23	235962	5.500	7.00	3.00	HJ-8811248	18
24	2007594	6.000	7.50	2.50	HJ-961240	18

Tapered Roller Bearing No.	Stock No.	A	B	C	D	Description	Minimum Sheave O.D. (in.)
02	2018294	1.750	3.27	3.00	3.00	25580-25520/566CARGO	10
03	2018295	1.750	3.27	4.50	4.00	25580-25520	10
04	2017495	2.000	4.25	2.94	2.75	NA-456-SW/452-D	12
05	2017498	2.756	4.33	2.34	2.19	JLM-813049-813010	12
06	2017499	2.756	4.72	2.94	2.75	NA-483-SW-472-D	12
07	2017500	3.940	6.10	3.03	2.88	JM720249N/720210N	16
08	2017501	4.250	6.50	3.50	3.38	NA56425-SW-56650D	16
09	2017502	5.625	7.88	3.69	3.50	NA48685-SW/48620	20
10	2017503	6.500	8.88	3.75	3.50	NA46790-SW-46720	22
11	2017504	8.00	10.88	3.75	3.62	LM241149NW/241110-D	24
12	2017506	10.500	13.88	4.25	4.12	LM251649NW/251610-D	26
Additional (T) Tapered Roller Bearing (With Seals) (not necessarily stocked)							
13	2023503	4.998	7.19	3.688	3.500	NA48290-SW/4822/OD	18
14	2022881	9.998	13.69	4.000	3.875	LM249747NW/LM249710D	22
15	2022882	11.998	15.500	4.250	4.125	L357049NW/L357010D	30

Roller Bearing with TW No.	Stock No.	Dimensions				Description	Minimum Sheave O.D. (in.) without Handling Holes
		A	B	C	D		
01	2017933	2.500	3.25	2.00	2.00	HJ-405228	10
02	2017934	3.000	3.75	2.00	2.00	HJ-486028	12
03	2017935	3.000	3.75	2.50	2.50	HJ-486028	12
04	2017936	3.500	4.50	2.00	2.00	HJ-567232	12
05	2017937	3.875	6.00	2.25	2.25	MR-72 / MI-62	16
06	2017938	3.875	6.00	2.25	2.25	MR-72 / MI-62	16
07	2017939	4.500	6.00	2.25	2.25	MR-72	16
08	2017940	5.000	6.50	2.25	2.25	HJ-8010436	16

## (B) Bronze Bushing

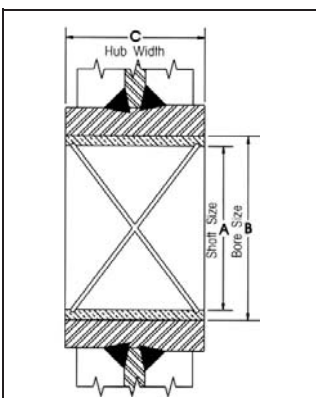

Bronze Bushings are equipped with S.A.E. 660 Bronze Bushings for cold finish shafts with "Figure 8" oil groove.

## (R) Roller Bearings

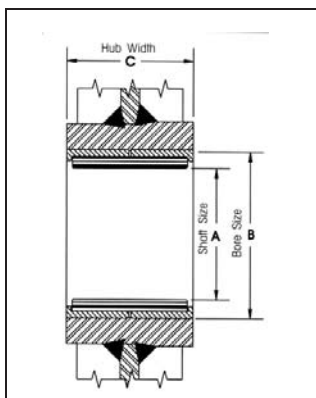

Roller bearings are designed to operate on shafts carburized to 60 Rockwell "C" and groove to +/- .0005 of shaft size.

## (T) Tapered Roller Bearing

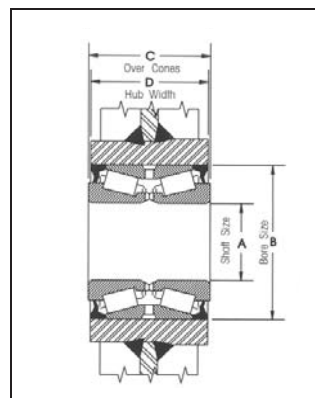

Tapered bearings are designed to operate on shafts machined to +/- .005 of the indicated shaft size. Applications should provide for tightening separator plates against bearing cones to adjust and insure proper function of bearings.

## (W) Roller Bearing With Thrust Washers

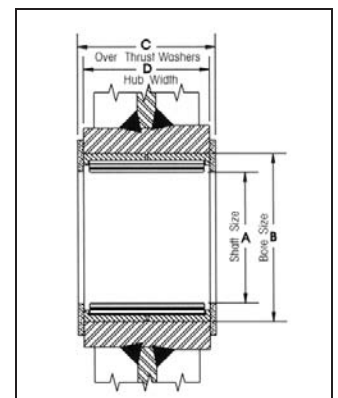

Roller bearings without inner races are designed to operate on shafts carburized to 60 Rockwell "C" and grooved to +/- .0005 of shaft size.

# McKissick<sup>®</sup> Roll Forged<sup>™</sup> Sheaves

## ROLL FORGED<sup>™</sup> SHEAVE CONFIGURATOR WORKSHEET

Customer Name			Date
Address			
City	State	Country	Zip
Phone		Fax	
Customer Contact Name			
E-Mail			Quantity

**Crosby, please quote on the following McKissick<sup>®</sup> Roll Forged<sup>™</sup> Sheave**  
**ALL SPACES MUST BE COMPLETE**

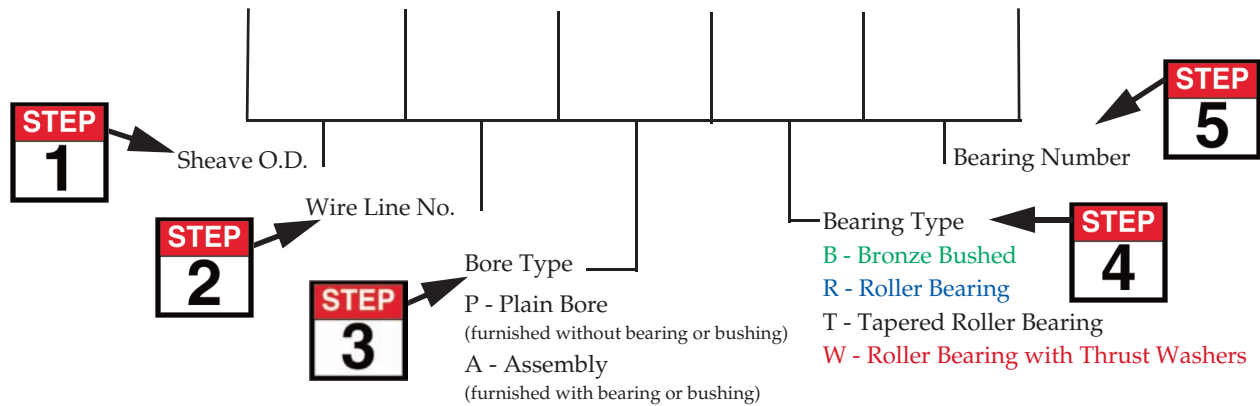

### Additional Information

#### Application Information

Line Pull	Fleet Angle	Degree of Wrap
Line Speed	Environment	

#### Special Testing

#### Finish

#### Third Party Inspection / Approval



**U.S.A.**  
 P.O. Box 3128  
 Tulsa, Ok 74101 - 3128  
 (918) 834-4611  
 FAX: (918) 832-0940  
 www.thecrosbygroup.com  
 crosbygroup@thecrosbygroup.com

**CANADA**  
 145 Heart Lake Road  
 Brampton, Ontario, Canada  
 (905) 451-9261  
 FAX: (877) 260-5106  
 www.crosby.ca  
 sales@crosby.ca

**BELGIUM**  
 Leuvensebaan 51  
 2580 Putte  
 (Mechelen) Belgium  
 32-15-75-71-25  
 FAX: 32-15-75-37-64  
 sales@crosbyeurope.com

# McKissick® Sheaves

**SEE APPLICATION AND WARNING INFORMATION**  
 Para Español: [www.thecrosbygroup.com](http://www.thecrosbygroup.com) See Pages 332-339

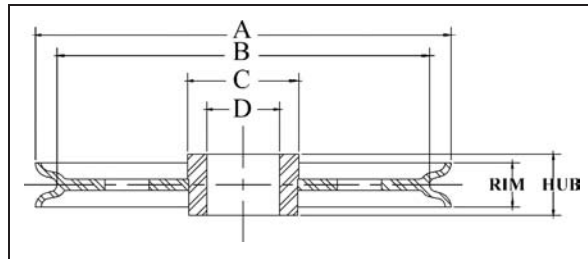

## Finished Bore Sheaves

- Roll Forged™ sheaves are available in sizes up to 1829mm in diameter.
- McKissick® Finished Bore Sheaves can be equipped with bushings or bearings at an optional charge.
- 356mm diameter sheaves and larger are Roll Forged™ with Flame hardened grooves to minimum Rockwell 35C.

"A" Nominal Outside Diameter (mm)*	Stock No.	Pattern Number	Wire Line Size (mm)	"D" Bore Size (mm)	Hub Width (mm)	Rim Width (mm)	"C" Nominal Hub Outside Dia. (mm)	"B" Nominal Tread Dia. (mm)	Material	Approx. Weight (kg)
76.0	51008	3X	6	19.1	33.3	31.8	28.6	52.5	B.S.	0.45
76.0	11310	3X	10	19.1	33.3	31.8	28.6	52.5	B.S.	0.45
-	-	-	-	-	-	-	-	-	-	-
102	51053	4-1	3	39.9	25.4	22.2	51.0	79.5	B.S.	0.91
102	51044	4-1	6	39.9	25.4	22.2	51.0	79.5	B.S.	0.91
102	1189	4-1	10	39.9	25.4	22.2	51.0	79.5	B.S.	0.91
-	-	-	-	-	-	-	-	-	-	-
102	2023185	4-K	10	39.9	38.1	34.9	51.0	76.0	F.S.	1.59
102	2023182	4-K	13	39.9	38.1	34.9	51.0	76.0	F.S.	1.59
102	51026	4-K	16	39.9	38.1	34.9	51.0	76.0	F.S.	1.59
-	-	-	-	-	-	-	-	-	-	-
108	50553	4-E	10	20.7	30.2	23.8	54.0	85.5	B.S.	1.09
108	25939	4-E	13	20.7	30.2	23.8	54.0	85.5	B.S.	1.09
-	-	-	-	-	-	-	-	-	-	-
121	51222	5-2	8	22.2	39.7	34.9	38.1	92.0	D.I.	1.59
121	51231	5-2	10	22.2	39.7	34.9	38.1	92.0	D.I.	1.59
121	11622	5-2	13	22.2	39.7	34.9	38.1	92.0	D.I.	1.59
-	-	-	-	-	-	-	-	-	-	-
124	2026411	5-1-B	10	44.4	31.8	28.6	57.0	103	F.S.	1.63
124	62149	5-1-B	10	46.9	33.3	28.6	57.0	103	F.S.	1.13
124	2026413	5-1-B	13	44.4	31.8	28.6	57.0	103	F.S.	1.63
124	2026409	5-1-B	16	44.4	31.8	28.6	57.0	103	F.S.	1.63
-	-	-	-	-	-	-	-	-	-	-
127	51071	5-1	8	28.6	25.4	22.2	38.1	102	F.S.	1.13
127	51062	5-1	10	28.6	25.4	22.2	38.1	102	F.S.	1.13
127	25948	5-1	11	28.6	25.4	22.2	38.1	102	F.S.	1.13
-	-	-	-	-	-	-	-	-	-	-
133	2026426	6-6	16	39.9	38.1	34.9	52.5	98.5	F.S.	1.81
133	2026422	6-6	19	39.9	38.1	34.9	52.5	98.5	F.S.	1.81
-	-	-	-	-	-	-	-	-	-	-
149	2023133	6-2	16	47.6	44.5	41.3	63.5	111	F.S.	2.72
149	2023136	6-2	19	47.6	44.5	41.3	63.5	111	F.S.	2.72
149	51302	6-2	22	47.6	44.5	41.3	63.5	111	F.S.	2.72
-	-	-	-	-	-	-	-	-	-	-
152	51124	6-1-B	10	41.3	28.6	25.4	57.0	125	F.S.	1.81
152	51375	6-8	13	34.9	38.1	31.8	79.5	121	B.S.	3.18
152	13014	6-1-B	13	41.3	28.6	25.4	57.0	125	F.S.	1.81
152	60695	6-8	13	60.5	44.5	31.8	79.5	121	F.S.	2.13
152	2023263	6NS-2	16	63.5	58.5	55.5	79.5	108	F.S.	4.31
152	1410	6-8	19	34.9	38.1	31.8	79.5	121	B.S.	3.18
152	2023257	6NS-2	19	63.5	58.5	55.5	79.5	108	F.S.	4.31
152	2023261	6NS-2	22	63.5	58.5	55.5	79.5	108	F.S.	4.31
-	-	-	-	-	-	-	-	-	-	-
178	61872	7-1	6	46.9	33.3	19.1	60.5	159	B.S.	1.81
178	51437	7-1	6	47.6	34.9	19.1	60.5	159	B.S.	2.81
178	3203	7-1	10	47.6	34.9	19.1	60.5	159	B.S.	2.81

McKissick Sheaves

# McKissick® Sheaves

"A" Nominal Outside Diameter (mm)*	Stock No.	Pattern Number	Wire Line Size (mm)	"D" Bore Size (mm)	Hub Width (mm)	Rim Width (mm)	"C" Nominal Hub Outside Dia. (mm)	"B" Nominal Tread Dia. (mm)	Material	Approx. Weight (kg)
-	-	-	-	-	-	-	-	-	-	-
191	2026452	8-7	16	39.9	38.1	34.9	52.5	176	F.S.	3.40
191	2026450	8-7	19	39.9	38.1	34.9	52.5	176	F.S.	3.40
-	-	-	-	-	-	-	-	-	-	-
194	51605	8-10	10	39.9	38.1	31.8	60.5	157	D.I.	3.18
194	5498	8-10	13	39.9	38.1	31.8	60.5	157	D.I.	3.18
194	51614	8-10	16	39.9	38.1	31.8	60.5	157	D.I.	3.18
-	-	-	-	-	-	-	-	-	-	-
203	2023466	8NS-3	26	70.0	63.5	60.5	102	133	F.S.	6.80
203	2023462	8NS-3	29	70.0	63.5	60.5	102	137	F.S.	6.80
203	2023152	8-2	19	47.7	44.5	41.3	65.0	160	F.S.	4.54
203	61710	8-2	13	46.9	33.3	31.8	62.0	168	F.S.	3.63
203	51589	8-2	13	47.6	38.1	34.9	62.0	168	F.S.	3.18
203	2023144	8-2	13	47.7	44.5	41.3	65.0	160	F.S.	4.54
203	51598	8-2	16	47.6	38.1	34.9	62.0	168	F.S.	3.18
203	2023146	8-2	16	47.7	44.5	41.3	65.0	160	F.S.	4.54
203	5194	8-2	19	47.6	38.1	34.9	62.0	168	F.S.	3.18
203	2028226	8NS-2	19	63.5	58.5	54.0	82.5	156	F.S.	5.67
203	2023403	8NS-2	19	65.0	58.5	54.0	82.5	156	F.S.	4.65
203	2023385	8NS-2	22	63.5	58.5	54.0	82.5	156	F.S.	5.67
203	2023765	8NS-5	28	102	63.5	60.5	127	138	C.S.	6.80
-	-	-	-	-	-	-	-	-	-	-
216	61747	8-DI-8	10	46.9	33.3	25.4	70.0	191	D.I.	4.99
-	-	-	-	-	-	-	-	-	-	-
248	2026492	10-NS-3	10	76.0	55.6	25.4	95.5	222	F.S.	4.08
-	-	-	-	-	-	-	-	-	-	-
251	51918	10-11	10	76.0	44.5	28.6	95.5	217	F.S.	6.35
251	51749	10-1	13	34.9	38.1	34.9	82.5	216	F.S.	4.31
251	2023154	10-2	13	47.6	44.5	41.3	65.0	211	F.S.	6.58
251	6040	10-11	13	76.0	44.5	28.6	95.5	217	B.S.	6.35
251	5675	10-1	16	34.9	38.1	34.9	82.5	216	F.S.	4.31
251	2023169	10-2	16	47.6	44.5	41.3	65.0	211	F.S.	6.58
251	2023173	10-2	19	47.6	44.5	41.3	65.0	211	F.S.	6.58
251	2023435	10NS-2	19	65.0	58.5	55.5	89.0	206	F.S.	7.30
251	2023419	10NS-2	22	63.5	58.5	55.5	89.0	206	F.S.	6.80
251	2023427	10NS-2	26	63.5	58.5	55.5	89.0	206	F.S.	6.80
-	-	-	-	-	-	-	-	-	-	-
254	2023484	10NS-3	28	70.0	63.5	60.5	102	187	F.S.	8.62
254	2023784	10NS-5	28	102	63.5	60.5	146	187	F.S.	12.3
-	-	-	-	-	-	-	-	-	-	-
302	62096	12-6	6	76.0	55.5	25.4	95.5	273	D.I.	5.44
302	6193	12-6	10	76.0	58.5	25.4	95.5	273	D.I.	5.08
-	-	-	-	-	-	-	-	-	-	-
305	2023247	12-1	16	47.7	44.5	41.3	82.5	257	F.S.	8.15
305	2023234	12-1	19	47.7	44.5	41.3	82.5	248	F.S.	8.15
305	2023251	12-1	22	47.7	44.5	41.3	82.5	260	F.S.	8.15
305	2026531	12-9	16	76.0	44.5	41.3	114	257	F.S.	7.26
305	52285	12-9	19	76.0	44.5	41.3	114	248	R.F.	7.26
305	52132	12-2-A	16	63.5	58.5	55.5	114	257	R.F.	10.9
305	52141	12-2-A	19	63.5	58.5	55.5	114	248	R.F.	10.9
305	60007	12-2-A	19	70.0	58.5	55.5	114	248	R.F.	10.9
305	2026537	12-2-A	19	76.0	55.5	55.5	114	248	R.F.	10.9
305	74724	12-2-A	19	76.0	58.5	55.5	114	248	R.F.	10.9
305	2632	12-2-A	22	63.5	58.5	55.5	114	260	R.F.	10.9
305	2023553	12NS-3	22	70.0	63.5	60.5	114	260	R.F.	12.7
305	62283	12-2-A	22	76.0	55.5	55.5	114	260	R.F.	10.9
305	4016594	12-9	22	76.0	44.5	41.3	114	260	R.F.	10.4
305	52150	12-2-A	26	63.5	58.5	55.5	102	238	R.F.	10.9
305	2023551	12NS-3	28	70.0	63.5	60.5	114	238	R.F.	10.9
-	-	-	-	-	-	-	-	-	-	-
330	33653	13-2	10	63.5	38.1	28.6	89.0	295	R.F.	6.35
330	50704	13-2	13	63.5	38.1	28.6	89.0	295	R.F.	6.35
-	-	-	-	-	-	-	-	-	-	-
356	* 52720	14WL-8	13	108	63.5	34.9	129	321	D.I.	6.80

\* Without Flame Hardening.  
Material: B.S.=Bar Steel, C.I.=Cast Iron, F.S.=Forged Steel, D.I.=Ductile Iron, C.S.=Cast Steel, P.M.=Powdered Metal, R.F.=Roll Forged.

# McKissick® Sheaves

**SEE APPLICATION AND WARNING INFORMATION**  
 Para Español: [www.thecrosbygroup.com](http://www.thecrosbygroup.com) See Pages 332-339

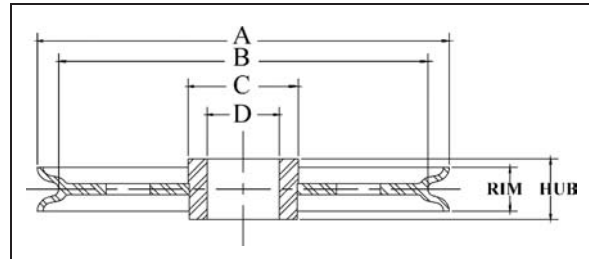

## Common Bore Sheaves

- Roll Forged™ sheaves are available in sizes up to 1829mm in diameter.
- Common Bore or Plain Bore are terms used when there is merely a hole bored in the center of the sheave.
- Common Bore Sheaves are machined for a running fit for the shaft size listed.

"A" Nominal Outside Diameter (mm)*	Stock No.	Pattern Number	Wire Line Size (mm)	"D" Bore Size (mm)	Hub Width (mm)	Rim Width (mm)	"C" Nominal Hub Outside Dia. (mm)	"B" Nominal Tread Dia. (mm)	Material	Approx. Weight (kg)
76.0	905051	1161	5	9.55	19.8	19.1	25.4	60.5	P.M.	0.45
76.0	905079	1161	5	12.7	19.8	19.1	25.4	60.5	P.M.	0.45
76.0	905097	1161	5	15.9	19.8	19.1	25.4	60.5	P.M.	0.45
76.0	905024	1161	6	9.55	12.7	12.7	25.4	66.5	P.M.	0.34
76.0	905042	1161	6	12.7	12.7	12.7	25.4	66.5	P.M.	0.34
76.0	15410	1161	10	9.55	19.8	19.1	25.4	60.5	P.M.	0.45
76.0	905088	1161	10	12.7	19.8	19.1	25.4	60.5	P.M.	0.45
76.0	905104	1161	10	15.9	19.8	19.1	25.4	60.5	P.M.	0.27
-	-	-	-	-	-	-	-	-	-	-
102	905113	1161	5	12.7	19.1	15.9	34.9	89.0	P.M.	0.45
102	905131	1161	5	15.9	19.1	15.9	34.9	89.0	P.M.	0.45
102	905122	1161	8	12.7	19.1	15.9	34.9	89.0	P.M.	0.45
102	905140	1161	8	15.9	19.1	15.9	34.9	89.0	P.M.	0.45
102	905168	1161	10	12.7	20.6	19.1	38.1	82.5	P.M.	0.57
102	905186	1161	10	15.9	20.6	19.1	38.1	82.5	P.M.	0.57
102	905202	1161	10	19.1	20.6	19.1	38.1	82.5	P.M.	0.57
102	905220	1161	13	12.7	27.0	25.4	41.3	81.0	P.M.	0.68
102	905248	1161	13	15.9	27.0	25.4	41.3	81.0	P.M.	0.68
102	905266	1161	13	19.1	27.0	25.4	41.3	81.0	P.M.	0.68
-	-	-	-	-	-	-	-	-	-	-
127	905275	1161	5	15.9	23.8	22.2	57.0	108	P.M.	1.02
127	905293	1161	5	19.1	23.8	22.2	57.0	108	P.M.	1.02
127	905284	1161	10	15.9	23.8	22.2	57.0	108	P.M.	1.25
127	905300	1161	10	19.1	23.8	22.2	57.0	108	P.M.	1.02
127	905328	1161	13	15.9	27.0	25.4	57.0	102	P.M.	1.13
127	905364	1161	13	15.9	30.2	28.6	57.0	102	D.I.	1.81
127	905346	1161	13	19.1	27.0	25.4	57.0	102	P.M.	1.13
127	905382	1161	13	19.1	30.2	28.6	57.0	102	D.I.	1.81
127	905408	1161	13	22.2	30.2	28.6	57.0	102	D.I.	1.81
-	-	-	-	-	-	-	-	-	-	-
152	905426	1161	10	12.7	20.6	19.1	47.6	127	D.I.	1.13
152	905480	1161	10	12.7	27.0	25.4	47.6	127	D.I.	1.13
152	905462	1161	10	15.9	20.6	19.1	47.6	127	P.M.	1.13
152	905523	1161	10	19.1	27.0	25.4	47.6	127	P.M.	1.89
152	909020	1181	13	22.2	27.0	25.4	47.6	124	P.M.	1.70
152	909066	1181	16	19.1	33.3	31.8	47.6	121	P.M.	1.70
152	909084	1181	16	22.2	33.3	31.8	47.6	121	P.M.	1.70
152	909100	1181	16	25.4	33.3	31.8	47.6	121	P.M.	1.70
152	909164	1181	19	25.4	39.7	38.1	76.2	117	P.M.	3.06
-	-	-	-	-	-	-	-	-	-	-
171	905694	1161	6	19.1	30.2	28.6	51.0	149	D.I.	2.27
171	905710	1161	6	25.4	30.2	28.6	51.0	149	D.I.	2.27
171	905701	1161	10	19.1	30.2	28.6	51.0	149	D.I.	2.27
171	905729	1161	10	25.4	30.2	28.6	51.0	149	D.I.	2.27
-	-	-	-	-	-	-	-	-	-	-
203	905747	1161	13	19.1	28.6	25.4	60.5	175	D.I.	2.27
203	905765	1161	13	22.2	28.6	25.4	60.5	175	D.I.	2.27

McKissick Sheaves

# McKissick® Sheaves

"A" Nominal Outside Diameter (mm)*	Stock No.	Pattern Number	Wire Line Size (mm)	"D" Bore Size (mm)	Hub Width (mm)	Rim Width (mm)	"C" Nominal Hub Outside Dia. (mm)	"B" Nominal Tread Dia. (mm)	Material	Approx. Weight (kg)
203	905783	1161	13	25.4	28.6	25.4	60.5	175	D.I.	3.86
203	905809	1161	16	19.1	34.9	31.8	51.0	165	D.I.	2.72
203	905827	1161	16	22.2	34.9	31.8	51.0	165	D.I.	3.06
203	909306	1181	16	22.2	34.9	31.8	63.5	168	D.I.	3.86
203	905845	1161	16	25.4	34.9	31.8	51.0	165	D.I.	3.06
203	909324	1181	16	25.4	34.9	31.8	63.5	168	D.I.	3.86
203	909342	1181	16	28.6	34.9	31.8	63.5	168	D.I.	3.86
203	909360	1181	16	31.8	34.9	31.8	63.5	168	D.I.	3.86
203	909388	1181	16	38.1	34.9	31.8	63.5	168	D.I.	3.86
-	-	-	-	-	-	-	-	-	-	-
254	905925	1161	13	22.2	28.6	25.4	73.0	222	D.I.	4.54
254	905943	1161	13	25.4	28.6	25.4	73.0	222	D.I.	4.54
254	905961	1161	16	19.1	34.9	31.8	51.0	216	D.I.	4.20
254	905989	1161	16	22.2	34.9	31.8	51.0	216	D.I.	4.20
254	909681	1181	16	22.2	34.9	31.8	76.0	216	D.I.	6.12
254	906005	1161	16	25.4	34.9	31.8	76.0	216	D.I.	4.20
254	909761	1181	16	38.1	34.9	31.8	76.0	216	D.I.	6.12
-	-	-	-	-	-	-	-	-	-	-
305	906041	1161	13	25.4	28.6	25.4	102	270	D.I.	7.48
305	906087	1161	13	31.8	28.6	25.4	102	270	D.I.	7.48
305	906121	1161	19	25.4	41.3	38.1	70.0	260	D.I.	8.28
305	910107	1181	19	25.4	41.3	38.1	133	260	D.I.	11.6
305	906149	1181	19	28.6	41.3	38.1	70.0	260	D.I.	8.28
305	910125	1181	19	28.6	41.3	38.1	133	260	D.I.	11.6
305	906167	1161	19	31.8	41.3	38.1	70.0	260	D.I.	8.28
305	910143	1181	19	31.8	41.3	38.1	133	260	D.I.	11.6
305	910161	1181	19	38.1	41.3	38.1	133	260	D.I.	11.6
305	906229	1161	22	31.8	51.0	44.5	95.5	254	D.I.	9.19
305	906247	1161	22	38.1	51.0	44.5	95.5	254	D.I.	9.19
-	-	-	-	-	-	-	-	-	-	-
356	*906283	1161	19	28.6	41.3	38.1	82.5	311	C.I.	12.0
356	*906309	1161	19	31.8	41.3	38.1	82.5	311	C.I.	12.0
356	*910456	1181	22	38.1	41.3	38.1	89.0	308	C.I.	15.4
356	*910447	1181	22	31.8	41.3	38.1	89.0	308	C.I.	15.4

\* Without Flame Hardening.  
Material: B.S.=Bar Steel, C.I.=Cast Iron, F.S.=Forged Steel, D.I.=Ductile Iron, C.S.=Cast Steel, P.M.=Powdered Metal, R.F.=Roll Forged.

  
**SEE APPLICATION AND  
WARNING INFORMATION**  
Para Español: [www.thecrosbygroup.com](http://www.thecrosbygroup.com) See Pages 332-339

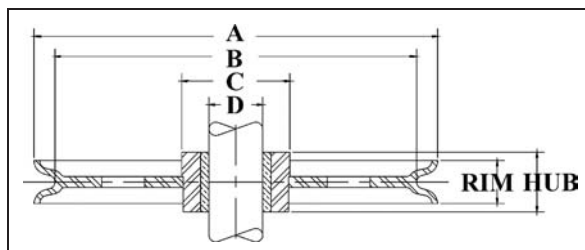

## Bronze Bushed Sheaves

- Roll Forged™ sheaves are available in sizes up to 1829mm in diameter.
- McKissick® Bronze Bushed Sheaves are equipped with S.A.E. 660 Bronze Bushings for cold finished shafts with "Figure 8" oil groove. For sizes not listed, McKissick® Finished Bore Sheaves can be equipped with bronze bushings at an optional charge.

"A" Nominal Outside Diameter (mm)*	Stock No.	Pattern Number	Wire Line Size (mm)	"D" Shaft Size (mm)	Hub Width (mm)	Rim Width (mm)	"C" Nominal Hub Outside Dia. (mm)	"B" Nominal Tread Dia. (mm)	Material	Approx. Weight (kg)
57.0	907004	1173	6	9.55*	15.9	14.3	19.1	47.6	B.S.	0.34
-	-	-	-	-	-	-	-	-	-	-
76.0	907059	1173	5	9.55*	19.8	19.1	25.4	60.5	P.M.	0.45
76.0	907077	1173	5	12.7*	19.8	19.1	25.4	60.5	P.M.	0.45
76.0	907095	1173	5	15.9*	19.8	19.1	25.4	60.5	P.M.	0.45
76.0	907022	1173	6	9.55*	12.7	12.7	25.4	66.5	P.M.	0.34

# McKissick® Sheaves

"A" Nominal Outside Diameter (mm)*	Stock No.	Pattern Number	Wire Line Size (mm)	"D" Shaft Size (mm)	Hub Width (mm)	Rim Width (mm)	"C" Nominal Hub Outside Dia. (mm)	"B" Nominal Tread Dia. (mm)	Material	Approx. Weight (kg)
76.0	907040	1173	6	12.7*	12.7	12.7	25.4	66.5	P.M.	0.34
76.0	460165	3X	6	12.7*	33.3	30.0	28.6	52.5	B.S.	0.45
76.0	2023201	3-1	8	19.1	25.4	22.2	44.5	57.0	P.M.	0.68
76.0	907068	1173	10	9.55*	19.1	19.1	25.4	60.5	P.M.	0.45
76.0	916101	1208	10	9.55*	19.8	19.1	38.1	60.5	B.S.	0.45
76.0	907086	1173	10	12.7*	19.1	19.1	25.4	60.5	P.M.	0.45
76.0	916110	1208	10	12.7*	19.8	19.1	38.1	60.5	B.S.	0.45
76.0	460156	3X	10	12.7	33.3	30.0	28.6	52.5	B.S.	0.45
76.0	907102	1173	10	15.9*	19.1	19.1	25.4	60.5	P.M.	0.45
76.0	2023196	3-1	10	19.1	25.4	22.2	44.5	57.0	P.M.	0.68
76.0	2023202	3-1	11	19.1	25.4	22.2	44.5	57.0	P.M.	0.68
76.0	916129	1208	13	9.55*	31.8	28.6	47.6	51.0	B.S.	0.60
76.0	916138	1208	13	12.7*	31.8	28.6	47.6	51.0	B.S.	0.68
-	-	-	-	-	-	-	-	-	-	-
102	460290	4-1	3	25.4	25.4	22.2	51.0	79.5	B.S.	0.91
102	907111	1173	5	12.7*	19.1	15.9	34.9	89.0	P.M.	0.45
102	907139	1173	5	15.9*	19.1	15.9	34.9	89.0	P.M.	0.45
102	916147	1208	6	12.7*	20.6	19.1	51.0	82.5	B.S.	0.68
102	916165	1208	6	19.1*	20.6	19.1	51.0	82.5	B.S.	0.68
102	460307	4-1	6	25.4	25.4	22.2	51.0	79.5	B.S.	0.91
102	907120	1173	8	12.7*	19.1	15.9	34.9	89.0	P.M.	0.45
102	907148	1173	8	15.9*	19.1	15.9	34.9	89.0	P.M.	0.45
102	907166	1173	10	12.7*	20.6	19.1	38.1	82.5	P.M.	0.57
102	916156	1208	10	12.7*	20.6	19.1	51.0	82.5	B.S.	0.68
102	907184	1173	10	15.9*	20.6	19.1	38.1	82.5	P.M.	0.64
102	907200	1173	10	19.1*	20.6	19.1	38.1	82.5	P.M.	0.57
102	460316	4-1	10	25.4	25.4	22.2	51.0	79.5	B.S.	0.91
102	907228	1173	13	12.7*	27.0	25.4	41.3	81.0	P.M.	0.68
102	916192	1208	13	12.7*	28.6	25.4	41.3	81.0	B.S.	0.91
102	907246	1173	13	15.9*	27.0	25.4	41.3	81.0	P.M.	0.68
102	907264	1173	13	19.1*	27.0	25.4	41.3	81.0	P.M.	0.68
102	916174	1208	10	19.1*	20.6	19.1	51.0	82.5	B.S.	0.68
-	-	-	-	-	-	-	-	-	-	-
105	2023186	4-K	10	25.4	38.1	34.9	51.0	76.0	F.S.	1.59
105	2023183	4-K	13	25.4	38.1	34.9	51.0	76.0	F.S.	1.59
105	2023188	4-K	16	25.4	38.1	34.9	51.0	76.0	F.S.	1.59
-	-	-	-	-	-	-	-	-	-	-
108	460450	4E	10	15.9*	30.2	23.8	54.0	85.5	B.S.	1.09
108	460441	4E	13	15.9*	30.2	23.8	54.0	85.5	B.S.	1.09
-	-	-	-	-	-	-	-	-	-	-
121	460575	5-2	8	15.9	39.7	34.9	38.1	92.0	D.I.	1.59
121	460584	5-2	10	15.9	39.7	34.9	38.1	92.0	D.I.	1.59
121	460593	5-2	13	15.9	39.7	34.9	38.1	92.0	D.I.	1.59
-	-	-	-	-	-	-	-	-	-	-
124	460478	5-1-B	10	31.8	31.8	28.6	57.0	103	F.S.	1.63
124	2026414	5-1-B	13	31.8	31.8	28.6	57.0	103	F.S.	1.63
124	460469	5-1-B	16	31.8	31.8	28.6	57.0	103	F.S.	1.63
-	-	-	-	-	-	-	-	-	-	-
127	907273	1173	5	15.9*	23.8	22.2	57.0	108	P.M.	1.02
127	907291	1173	5	19.1*	23.8	22.2	57.0	108	P.M.	1.02
127	460511	5-1	8	19.1	25.4	22.2	38.1	102	F.S.	1.13
127	907282	1173	10	15.9*	23.8	22.2	57.0	108	P.M.	1.02
127	907308	1173	10	19.1*	23.8	22.2	57.0	108	P.M.	1.02
127	460520	5-1	10	19.1	25.4	22.2	38.1	102	F.S.	1.13
127	460539	5-1	11	19.1	25.4	22.2	38.1	102	F.S.	1.13
127	907326	1173	13	15.9*	27.0	25.4	57.0	102	P.M.	1.13
127	907362	1173	13	15.9*	30.2	28.6	57.0	102	D.I.	1.81
127	907344	1173	13	19.1*	30.2	25.4	57.0	102	P.M.	1.13
127	907380	1173	13	19.1*	30.2	28.6	57.0	102	D.I.	1.81
127	907406	1173	13	22.2*	30.2	28.6	57.0	102	D.I.	1.81
-	-	-	-	-	-	-	-	-	-	-
133	460628	6-6	16	25.4	38.1	34.9	52.5	98.5	F.S.	1.81
133	460637	6-6	19	25.4	38.1	34.9	52.5	98.5	F.S.	1.81
-	-	-	-	-	-	-	-	-	-	-
149	2023129	6-2	16	38.1	44.5	41.3	63.5	111	F.S.	2.72
149	2023137	6-2	19	38.1	44.5	41.3	63.5	111	F.S.	2.72
149	2023135	6-2	22	38.1	44.5	41.3	63.5	111	F.S.	2.72
-	-	-	-	-	-	-	-	-	-	-
152	907424	1173	10	12.7*	20.6	19.1	47.6	127	P.M.	1.13
152	907488	1173	10	12.7*	27.0	25.4	47.6	127	P.M.	1.13
152	907442	1173	10	15.9*	20.6	19.1	47.6	127	P.M.	1.13

McKissick Sheaves

# McKissick® Sheaves

"A" Nominal Outside Diameter (mm)†	Stock No.	Pattern Number	Wire Line Size (mm)	"D" Shaft Size (mm)	Hub Width (mm)	Rim Width (mm)	"C" Nominal Hub Outside Dia. (mm)	"B" Nominal Tread Dia. (mm)	Material	Approx. Weight (kg)
152	907503	1173	10	15.9*	27.0	25.4	47.6	127	P.M.	1.13
152	907460	1173	10	19.1*	20.6	19.1	47.6	127	P.M.	1.13
152	907521	1173	10	19.1*	27.0	25.4	47.6	127	P.M.	1.13
152	2026483	6-1	10	19.1*	27.0	25.4	51.0	130	F.S.	1.81
152	916245	6-1	10	22.2*	27.0	25.4	51.0	130	F.S.	1.81
152	2026826	6-1	10	25.4*	27.0	25.4	51.0	130	F.S.	1.81
152	460682	6-1-B	10	31.8	28.4	25.4	57.0	125	F.S.	1.68
152	907549	1173	13	15.9*	30.2	28.6	47.6	124	P.M.	2.27
152	907567	1173	13	19.1*	30.2	28.6	47.6	124	P.M.	2.14
152	913024	1193	13	22.2*	27.0	25.4	47.6	124	P.M.	1.70
152	460879	6-8	13	25.4	38.1	31.8	79.5	121	B.S.	3.18
152	460673	6-1-B	13	31.8*	28.6	25.4	57.0	125	F.S.	1.81
152	2028048	1193	13	25.4*	27.0	25.4	47.6	124	P.M.	4.31
152	2026938	6-1	16	19.1*	27.0	25.4	51.0	130	F.S.	3.18
152	913060	1193	16	19.1*	33.3	31.8	47.6	121	P.M.	1.81
152	916254	6-1	16	22.2*	27.0	25.4	51.0	130	F.S.	1.81
152	913088	1193	16	22.2	33.3	31.8	47.6	121	P.M.	1.70
152	2026822	6-1	16	25.4*	27.0	25.4	51.0	130	F.S.	1.81
152	913104	1193	16	25.4*	33.3	31.8	47.6	121	P.M.	1.70
152	2023264	6NS-2	16	51.0	58.5	55.5	79.5	108	F.S.	4.31
152	460897	6-8	19	25.4	38.1	31.8	79.5	121	B.S.	3.18
152	913168	1193	19	25.4	39.7	38.1	76.0	117	P.M.	3.06
152	2023260	6NS-2	19	51.0	58.5	55.5	79.5	108	F.S.	4.31
152	2023262	6NS-2	22	51.0	58.5	55.5	79.5	108	F.S.	4.31
-	-	-	-	-	-	-	-	-	-	-
171	907692	1173	6	19.1*	30.2	28.6	51.0	149	D.I.	2.27
171	907718	1173	6	25.4*	30.2	28.6	51.0	149	D.I.	2.27
171	907709	1173	10	19.1*	30.2	28.6	51.0	149	D.I.	2.27
171	907727	1173	10	25.4*	30.2	28.6	51.0	149	D.I.	2.27
-	-	-	-	-	-	-	-	-	-	-
178	461020	7-1	6	38.1	34.9	19.1	60.5	159	B.S.	2.81
178	461039	7-1	10	38.1	34.9	19.1	60.5	159	B.S.	2.81
178	907629	1173	13	19.1*	27.0	25.4	51.0	143	D.I.	1.93
178	907647	1173	13	22.2*	27.0	25.4	51.0	143	D.I.	1.93
-	-	-	-	-	-	-	-	-	-	-
191	460986	8-7	16	25.4	38.1	34.9	52.5	160	F.S.	3.40
191	460977	8-7	19	25.4	38.1	34.9	52.5	160	F.S.	3.40
-	-	-	-	-	-	-	-	-	-	-
194	461262	8-10	10	25.4	38.1	31.8	60.5	157	D.I.	3.18
194	461280	8-10	13	25.4	38.1	31.8	60.5	157	D.I.	3.18
194	461271	8-10	16	25.4	38.1	31.8	60.5	157	D.I.	3.18
203	2023467	8NS-3	26	57.0	63.5	60.3	114	137	F.S.	8.16
203	2023463	8NS-3	28	57.0	63.5	60.3	114	137	F.S.	8.16
203	2023153	8-2	19	38.1	44.5	41.3	65.0	160	F.S.	4.54
203	907745	1173	13	19.1*	28.6	25.4	60.5	175	D.I.	2.27
203	916487	8-1	13	19.1*	34.9	31.8	51.0	168	F.S.	3.18
203	907763	1173	13	22.2*	28.6	25.4	60.5	175	D.I.	2.27
203	916502	8-1	13	22.2*	34.9	31.8	51.0	168	F.S.	3.18
203	907781	1173	13	25.4*	28.6	25.4	60.5	175	D.I.	2.27
203	916520	8-1	13	25.4*	34.9	31.8	51.0	168	F.S.	3.18
203	2026841	8-1	13	28.6*	34.9	31.8	51.0	168	F.S.	3.18
203	2026844	8-1	13	31.8*	34.9	31.8	51.0	168	F.S.	3.18
203	461235	8-2	13	38.1	38.1	34.9	62.0	168	F.S.	3.18
203	2023145	8-2	13	38.1	44.5	41.3	65.0	160	F.S.	4.54
203	907807	1173	16	19.1*	34.9	31.8	51.0	165	D.I.	3.06
203	913300	1193	16	22.2*	34.9	31.8	51.0	165	D.I.	3.06
203	913328	1193	16	25.4*	34.9	31.8	63.5	168	D.I.	3.86
203	913346	1193	16	28.6*	34.9	31.8	63.5	168	D.I.	3.86
203	913364	1193	16	31.8*	34.9	31.8	63.5	168	D.I.	3.86
203	913382	1193	16	38.1*	34.9	31.8	63.5	168	D.I.	3.86
203	461244	8-2	16	38.1	38.1	34.9	62.0	168	F.S.	3.18
203	2023147	8-2	16	38.1	44.5	41.3	65.0	160	F.S.	4.54
203	461253	8-2	19	38.1	38.1	34.9	62.0	168	F.S.	3.18
203	2028227	8NS-2	19	51.0	58.5	54.0	82.5	156	F.S.	5.67
203	461397	8NS-2-RB	19	70.0	58.5	55.5	95.5	152	R.F.	4.76
203	2023386	8NS-2	22	51.0	58.5	54.0	82.5	156	F.S.	5.67
203	461501	8NS-5	32	89.0	63.5	60.5	127	138	C.S.	6.80
-	-	-	-	-	-	-	-	-	-	-
251	462831	10-11	10	63.5	44.5	28.6	95.0	217	F.S.	6.35
251	462154	10-1	13	25.4*	38.1	34.9	82.5	216	F.S.	4.31

# McKissick® Sheaves

"A" Nominal Outside Diameter (mm)*	Stock No.	Pattern Number	Wire Line Size (mm)	"D" Shaft Size (mm)	Hub Width (mm)	Rim Width (mm)	"C" Nominal Hub Outside Dia. (mm)	"B" Nominal Tread Dia. (mm)	Material	Approx. Weight (kg)
251	2023166	10-2	13	38.1	44.5	41.3	65.0	211	F.S.	6.58
251	462840	10-11	13	63.5	44.5	28.6	95.5	217	F.S.	6.35
251	462163	10-1	16	25.4*	38.1	34.9	82.5	216	F.S.	4.31
251	2023170	10-2	16	38.1	44.5	41.3	65.0	211	F.S.	6.58
251	2023174	10-2	19	38.1	44.5	41.3	65.0	211	F.S.	6.58
251	2023420	10NS-2	22	51.0	58.5	55.5	89.0	206	F.S.	6.80
251	2023428	10NS-2	25	51.0	58.5	55.5	89.0	206	F.S.	6.80
-	-	-	-	-	-	-	-	-	-	-
254	2026861	10NS-3	28	57.0	63.5	60.5	114	187	F.S.	12.3
254	2023785	10NS-5	28	89.0	63.5	60.5	146	187	F.S.	12.7
254	907923	1173	13	22.2*	28.6	25.4	73.0	222	D.I.	4.54
254	907941	1173	13	25.4*	28.6	25.4	73.0	222	D.I.	5.35
254	907969	1173	16	19.1*	34.9	31.8	51.0	216	D.I.	4.20
254	916717	10-1	16	22.2*	34.9	31.8	70.0	216	F.S.	4.54
254	913685	1193	16	22.2*	34.9	31.8	76.0	216	D.I.	6.12
254	908003	1173	16	25.4*	34.9	31.8	51.0	216	D.I.	4.20
254	916726	10-1	16	25.4*	34.9	31.8	70.0	216	F.S.	6.35
254	2027291	10-1	16	31.8*	34.9	31.8	70.0	216	F.S.	6.35
254	913765	1193	16	38.1*	34.9	31.8	76.0	216	D.I.	5.72
254	913863	10-1	19	38.1*	41.3	38.1	89.0	210	F.S.	7.26
254	916824	1208	19	31.8*	41.3	38.1	89.0	197	F.S.	7.71
254	913845	10-1	19	31.8*	41.3	38.1	89.0	210	F.S.	7.26
254	916833	1208	19	38.1*	41.3	38.1	82.5	197	F.S.	7.71
254	913807	10-1	19	25.4*	41.3	38.1	89.0	210	F.S.	7.26
-	-	-	-	-	-	-	-	-	-	-
302	462323	12-6	10	63.5	58.7	25.4	95.5	273	D.I.	5.08
-	-	-	-	-	-	-	-	-	-	-
305	2023227	12-1	16	38.1	44.5	41.3	82.5	260	F.S.	9.98
305	2023235	12-1	19	38.1	44.5	41.3	82.5	238	F.S.	9.98
305	2023252	12-1	22	38.1	44.5	41.3	82.5	260	F.S.	9.98
305	462564	12-9	16	63.5	44.5	41.3	114	271	R.F.	10.9
305	462573	12-9	19	63.5	44.5	41.3	114	238	R.F.	10.9
305	908049	1173	13	25.4*	28.6	25.4	102	270	D.I.	7.48
305	908085	1173	13	31.8*	28.6	25.4	102	270	D.I.	7.48
305	917002	1208	16	25.4*	41.3	38.1	82.5	257	F.S.	8.16
305	917011	1208	16	28.6*	41.3	38.1	82.5	257	F.S.	8.16
305	462387	12-2A	16	51.0*	58.5	55.5	114	257	R.F.	11.8
305	908129	1173	19	25.4*	41.3	38.1	70.0	260	D.I.	8.28
305	908147	1173	19	28.6	41.3	38.1	70.0	260	D.I.	8.28
305	914121	1193	19	28.6*	41.3	38.1	133	260	D.I.	11.6
305	914149	1193	19	31.8	41.3	38.1	133	260	D.I.	11.6
305	914167	1193	19	38.1	41.3	38.1	133	260	D.I.	11.6
305	346593	12-2-A	19	57.0	58.5	55.5	114	248	R.F.	11.8
305	4104882	12-9	19	63.5	44.5	41.3	114	248	R.F.	11.3
305	462449	12-2-A	19	51.0	58.5	55.5	114	248	R.F.	11.8
305	4104917	12-2-A	19	63.5*	58.5	55.5	114	248	R.F.	11.3
305	462485	12-5	19	76.0*	76.0	47.6	140	238	R.F.	9.53
305	908227	1173	22	31.8	51.0	44.5	95.5	254	D.I.	9.19
305	908245	1173	22	38.1	51.0	44.5	95.5	254	D.I.	9.19
305	462458	12-2-A	22	51.0	58.5	55.5	114	260	R.F.	11.8
305	2023554	12-NS-3	22	57.0	63.5	60.5	114	238	R.F.	12.7
305	4104891	12-9	22	63.5	44.5	41.3	114	260	R.F.	11.3
305	462467	12-2-A	25	51.0	58.5	55.5	102	254	R.F.	11.8
305	2023552	12-NS-3	32	57.0	63.5	60.5	114	238	R.F.	11.8
-	-	-	-	-	-	-	-	-	-	-
330	462779	13-2	10	51.0	38.1	28.6	89.0	295	R.F.	6.35
330	462788	13-2	13	51.0	38.1	28.6	89.0	295	R.F.	6.35
-	-	-	-	-	-	-	-	-	-	-
356	**463518	14WL-8	13	95.5*	63.5	34.9	114	321	D.I.	6.80
356	**908281	1173	19	28.6*	41.3	36.3	114	311	C.I.	12.0
356	**908307	1173	19	31.8*	41.3	38.1	82.5	311	C.I.	12.0
356	**914443	1193	22	31.8*	41.3	38.1	140	308	C.I.	15.4
356	**914452	1193	22	38.1	41.3	38.1	102	308	C.I.	15.4

\* Self Lubricating Bronze Bushing

\*\* Without Flame Hardening.

Material: B.S.=Bar Steel, C.I.=Cast Iron, F.S.=Forged Steel, D.I.=Ductile Iron, C.S.=Cast Steel, P.M.=Powdered Metal, R.F.=Roll Forged.

# McKissick® Sheaves

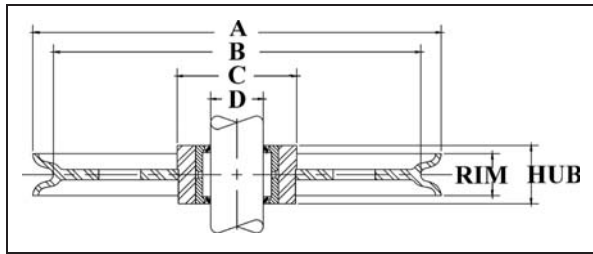

**SEE APPLICATION AND WARNING INFORMATION**

Para Español: [www.thecrosbygroup.com](http://www.thecrosbygroup.com)

See Pages 332-339

## Roller Bearing Sheaves

- Roll Forged™ sheaves are available in sizes up to 1829mm in diameter.
- McKissick® Roller Bearing Sheaves are designed to operate on shafts carburized to 60 Rockwell "C" and ground to +/- .0005 of the indicated shaft size. Some sizes are available with an optional inner race. Check with Crosby Sales for prices and correct shaft size.
- Application should provide for 0,8 mm running clearance over the hub width.
- For sizes not listed, McKissick® Finished Bore Sheaves can be equipped with Roller Bearings at an optional charge.

"A" Nominal Outside Diameter (mm)*	Stock No.	Pattern Number	Wire Line Size (mm)	"D" Shaft Size (mm)	Hub Width (mm)	Rim Width (mm)	"C" Nominal Hub Outside Dia. (mm)	"B" Nominal Tread Dia. (mm)	Material	Approx. Weight (kg)
102	472508	4-1	3	25.3	25.4	22.2	51.0	79.5	B.S.	0.91
102	472517	4-1	6	25.3	25.4	22.2	51.0	79.5	B.S.	0.91
102	472535	4-1	10	25.3	25.4	22.2	51.0	79.5	B.S.	0.91
-	-	-	-	-	-	-	-	-	-	-
102	2025893	4-K	10	25.3	38.1	34.9	51.0	76.0	F.S.	1.59
102	2028063	4-K	13	25.3	38.1	34.9	51.0	76.0	F.S.	1.59
102	2025891	4-K	16	25.3	38.1	34.9	51.0	76.0	F.S.	1.59
-	-	-	-	-	-	-	-	-	-	-
124	472768	5-1-B	10	31.7	31.8	28.6	57.0	103	F.S.	1.63
124	472777	5-1-B	13	31.7	31.8	28.6	57.0	103	F.S.	1.63
124	472786	5-1-B	16	31.7	31.8	28.6	57.0	103	F.S.	1.63
-	-	-	-	-	-	-	-	-	-	-
133	2026427	6-6	16	25.3	38.1	34.9	52.5	98.5	F.S.	1.81
133	2026423	6-6	19	25.3	38.1	34.9	52.5	98.5	F.S.	1.81
-	-	-	-	-	-	-	-	-	-	-
149	2023141	6-2	16	38.0	44.5	41.3	63.5	111	F.S.	2.72
149	2023143	6-2	19	38.0	44.5	41.3	63.5	111	F.S.	2.72
149	2023142	6-2	22	38.0	44.5	41.3	63.5	111	F.S.	2.72
-	-	-	-	-	-	-	-	-	-	-
152	472875	6-8	13	50.5	44.5	31.8	79.5	121	F.S.	3.18
-	-	-	-	-	-	-	-	-	-	-
191	2025898	8-7	16	25.3	38.1	34.9	52.5	160	F.S.	3.40
191	2025892	8-7	19	25.3	38.1	34.9	52.5	160	F.S.	3.40
-	-	-	-	-	-	-	-	-	-	-
194	473311	8-10	10	25.3	38.1	31.8	60.5	157	D.I.	3.18
194	473320	8-10	13	25.3	38.1	31.8	60.5	157	D.I.	3.18
194	473339	8-10	16	25.3	38.1	31.8	60.5	157	D.I.	3.18
-	-	-	-	-	-	-	-	-	-	-
203	2023163	8-2	19	38.0	44.5	41.3	65.0	160	F.S.	4.54
203	2023155	8-2	13	38.0	44.5	41.3	65.0	160	F.S.	4.54
203	2023159	8-2	16	38.0	44.5	41.3	65.0	160	F.S.	4.54
203	2023404	8NS-2	19	50.5	58.5	54.0	82.5	156	F.S.	5.67
-	-	-	-	-	-	-	-	-	-	-
251	2026433	10-2	13	38.0	44.5	41.3	65.0	211	F.S.	6.58
251	2023179	10-2	16	38.0	44.5	41.3	65.0	211	F.S.	6.58
251	2023181	10-2	19	38.0	44.5	41.3	65.0	211	F.S.	6.58
251	2023436	10NS-2	19	50.5	58.5	55.6	89.0	206	F.S.	6.80
-	-	-	-	-	-	-	-	-	-	-
305	2023248	12-1	16	38.0	44.5	41.3	82.5	257	F.S.	8.16
305	2023236	12-1	19	38.0	44.5	41.3	82.5	248	F.S.	8.16
305	2026441	12-1	22	38.0	44.5	41.3	82.5	260	F.S.	8.16
305	474365	12-9	16	57.0	44.5	41.3	114	257	R.F.	7.26
305	474374	12-9	19	57.0	44.5	41.3	114	248	R.F.	7.26

\* Without Flame Hardening.

Material: B.S.=Bar Steel, C.I.=Cast Iron, F.S.=Forged Steel, D.I.=Ductile Iron, C.S.=Cast Steel, P.M.=Powdered Metal, R.F.=Roll Forged.

# McKissick® Sheaves

**SEE APPLICATION AND WARNING INFORMATION**  
 Para Español: [www.thecrosbygroup.com](http://www.thecrosbygroup.com) See Pages 332-339

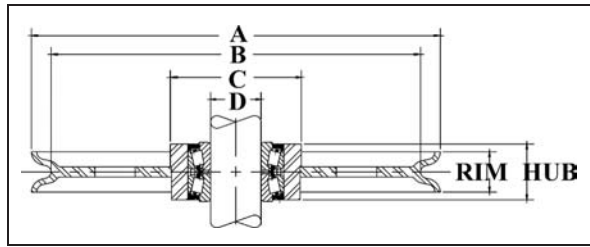

## Tapered Bearing Sheaves

- Roll Forged™ sheaves are available in sizes up to 1829mm in diameter.
- McKissick® Tapered Bearing Sheaves are designed to operate on shafts machined to  $\pm .0005''$  of the indicated shaft size. Applications should provide for tightening separator plates against bearing cones to adjust and insure proper function of bearing. For sizes not listed, McKissick® Finished Bore Sheaves can be equipped with tapered bearing at an optional charge.

"A" Nominal Outside Diameter (mm)*	Stock No.	Pattern Number	Wire Line Size (mm)	"D" Shaft Size (mm)	Hub Width (mm)	Rim Width (mm)	"C" Nominal Hub Outside Dia. (mm)	"B" Nominal Tread Dia. (mm)	Material	Approx. Weight (kg)
124	480269	5-1	10	19.0	34.9	28.6	57.0	103	F.S.	1.63
-	-	-	-	-	-	-	-	-	-	-
178	480777	7-1	6	19.0	34.9	19.1	60.5	159	B.S.	4.08
-	-	-	-	-	-	-	-	-	-	-
203	481017	8-2	13	19.0	34.9	31.8	62.0	168	F.S.	3.18
-	-	-	-	-	-	-	-	-	-	-
216	481044	8DI-8	10	19.0	34.9	25.4	70.0	191	D.I.	3.40
-	-	-	-	-	-	-	-	-	-	-
248	481295	10-NS-3	10	38.1	58.5	25.4	95.5	222	F.S.	5.08
-	-	-	-	-	-	-	-	-	-	-
302	481552	12-6	6	38.1	58.5	25.4	95.5	273	D.I.	5.44
-	-	-	-	-	-	-	-	-	-	-
305	481455	12-2-A	19	38.1	58.5	55.5	114	248	R.F.	10.9
305	481446	12-2-A	22	38.1	58.5	55.5	114	260	R.F.	10.9

Material: B.S.=Bar Steel, C.I.=Cast Iron, F.S.=Forged Steel, D.I.=Ductile Iron, C.S.=Cast Steel, P.M.=Powdered Metal, R.F.=Roll Forged.

McKissick  
Sheaves

# Western Block Sheaves



**SEE APPLICATION AND WARNING INFORMATION**

Para Español: [www.thecrosbygroup.com](http://www.thecrosbygroup.com)

See Pages 332-339

## IRON SHEAVES FOR USE WITH MANILA ROPE BLOCKS

- 1101 — 1141 Common Iron Bushed
- 1102 — 1142 Roller Bushed
- 1103 — 1143 Bronze Bushed, Self-Lubricating

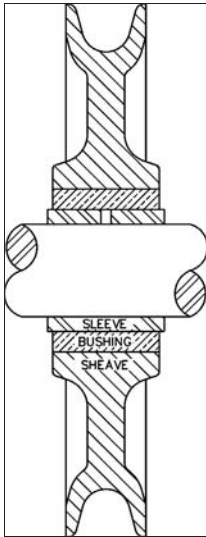

- FOR REGULAR MANILA ROPE BLOCKS

Block Size (mm)	Stock No.			Manila Rope Size (mm)	Sheave Size (mm)			Weight Each (kg.)
	1101 Galv.	1102 Galv.	1103 Galv.		Outside Dia. (A)	Rim Width (B)	Bore Size (C)	
76.2	900010	900216	900412	10	44.5	12.7	9.55	.11
102	900038	900234	900430	13	57.0	15.9	9.55	.34
127	900056	900252	900458	16	76.0	19.1	9.55	.23
152	900074	900270	900476	19	89.0	25.4	12.7	.45
178	900092	900298	900494	22	108	25.4	12.7	.57
203	900118	900314	900519	25	121	28.6	15.9	.79

Block Size (mm)	Stock No.			Manila Rope Size (mm)	Sheave Size (mm)			Sleeve Diameter (mm)		Weight Each (kg.)
	1141 Galv.	1142 Galv.	1143 Galv.		Outside Diam.	Rim Width	Bearing Diam. (C)	I.D. (F)	O.D. (E)	
152	902018	902214	902410	19	76.0	28.6	19.1	12.7	19.1	.45
178	902036	902232	902438	22	89.0	31.8	19.1	12.7	19.1	.91
203	902054	902250	902456	25	114	34.9	22.2	15.9	22.2	1.36
254	902072	902278	902474	32	146	47.6	25.4	19.1	25.4	3.18
304	902090	902296	902492	38	171	54.0	25.4	19.1	25.4	5.44

## FOR MANILA AND WIRE ROPE SNATCH BLOCKS

- 1298 - Bronzed Brushed, Self-Lubricating Steel sheave for Wire Rope.
- 1192 - Bronzed Brushed, Self-Lubricating Iron sheave for Wire Rope.
- 1293 - Bronzed Brushed, Self-Lubricating Steel sheave for Manila Rope.

Snatch Block		Stock No.		1192 Wire Line Size	1293 Painted Stock No.	1293 Manila Rope Size	Outside Dia.	Hub Width	Rim Width	Bore Size	Bush-ing I.D.	Sleeve Dimensions (mm)			Weight Each (kg)		
Style	Shell Length	1298 Painted	1192 Painted									I.D.	O.D.	Length	1298	1192	1293
924	-	922005	-	16	-	-	152	34.9	31.8	41.3	31.8	25.4	31.8	38.1	2.72	-	-
924	-	922023	-	19	-	-	203	41.3	38.1	47.6	38.1	31.8	38.1	44.5	4.99	-	-
924	-	922041	-	22	-	-	254	41.3	38.1	63.5	50.8	38.1	50.8	44.5	8.62	-	-
924	-	922069	-	22	-	-	305	50.8	44.5	63.5	50.8	38.1	50.8	54.0	9.98	-	-
940-941	-	922078	920579	10	-	-	102	20.6	19.1	28.6	19.1	12.7	19.1	22.2	1.36	.90	-
940-941	-	922087	920588	13	-	-	152	27.0	25.4	34.9	25.4	19.1	25.4	28.6	3.18	2.25	-
940-941	-	922103	920604	16	-	-	203	34.9	31.8	38.1	28.6	22.2	28.6	38.1	3.63	4.50	-
940-941	-	922121	920622	16	-	-	254	34.9	31.8	41.3	31.8	25.4	31.8	38.1	5.44	7.70	-
940-941	-	922149	920640	19	-	-	305	41.3	38.1	47.6	38.1	31.8	38.1	44.5	17.7	14.5	-
1096	152	-	-	-	921505	22.2	76	41.3	28.6	41.3	25.4	15.9	32.1	38.1	-	-	.90
1096	203	-	-	-	921523	1	114	41.3	41.3	41.3	32.0	7/8	32.1	38.1	-	-	2.70
961	-	922407	-	16	-	-	152	41.3	38.1	50.8	41.3	31.8	41.3	41.3	4.08	-	-
961	-	922425	-	22	-	-	203	42.9	38.1	63.5	50.8	--	--	--	6.80	-	-

# McKissick® API Roll Forged Sheaves

McKissick® Products has been licensed by the American Petroleum Institute to manufacture "Roll Forged"™ Sheaves under API specifications 8A & 8C.

- API sheaves must meet the criteria established by the American Petroleum Institute for drilling and production hoisting equipment.

- Typical Oilfield applications include:
  - Heavy Haul Trucking
  - Workover and Well Servicing Units
  - Tubing Blocks
  - Traveling Blocks
  - Crown Block Blocks



Licensed Under  
API Spec 8A-0023  
& 8C-0021.

- McKissick manufactures all "Roll Forged"™ sheaves to minimal API Specifications for general use in hoisting and wire rope guide applications.
- Grooves are flame hardened to min. RC35 on 14" and larger O.D. as standard.

## TYPICAL API SHEAVE RIM PROFILE

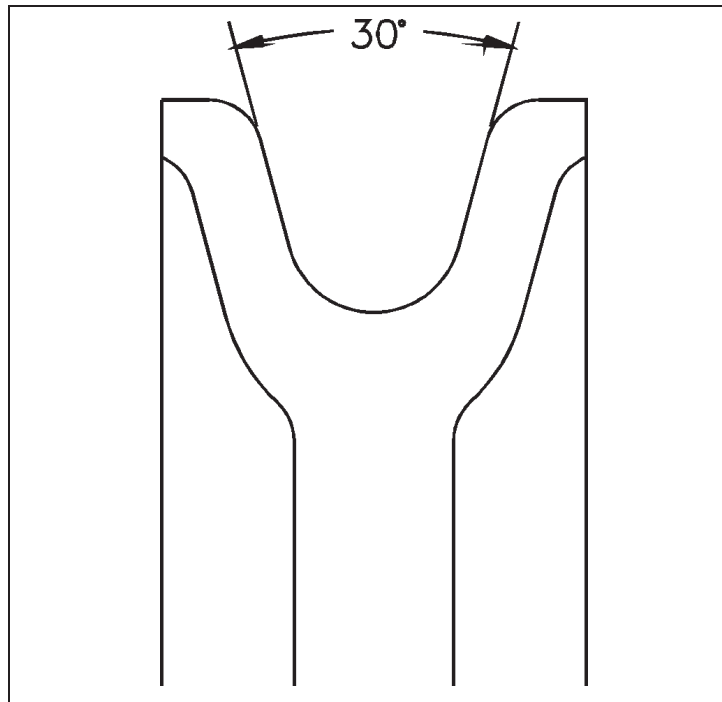

For additional information concerning API sheaves, contact:

**In U.S.A.** - Crosby's Special Engineered Product Group at 1-800-777-1555

**In Canada** - Crosby Canada at (905) 451-9261

**In Europe** - N.V. Crosby Europe at 32-15-757125

# McKissick® AISE Roll Forged Sheaves

McKissick® manufactures special "Roll Forged"™ Sheaves to meet the Specifications of AISE Standard Number 6.

- AISE Sheaves must meet specified criteria established by the Association of Iron and Steel Engineers for special use in electric overhead Traveling Cranes for Steel Mill Service.
- Other typical applications that may specify AISE sheaves:
  - Mobile Cranes
  - Portal Cranes
  - Power Shovels
  - Other equipment using wire rope

## Typical AISE Sheave Rim Profile with Specified Dimensional Requirements

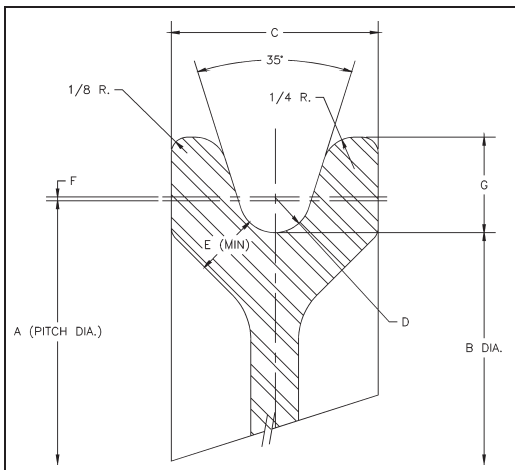

Sheave Wheel Contours							
Rope Diameter* (mm)	Dimensions (mm)						
	A	B	C	D	E	F	G
13	381	368	44.5	7.1	12.7	0.8	19.1
16	476	461	51.0	8.7	16.0	0.8	23.8
19	572	552	57.0	10.3	19.1	0.8	28.6
22	667	645	63.5	12.3	22.2	1.2	33.4
25	762	737	70.0	13.9	25.4	1.2	38.1
28	857	829	76.0	15.4	28.6	1.2	42.9
32	953	921	82.5	17.5	31.8	1.6	47.6
35	1048	1013	89.0	19.1	34.9	1.6	52.5
38	1143	1105	95.5	20.6	38.1	1.6	57.0

\* Sheaves with other wireline sizes are available upon request. Other pitch diameters available on application basis. Grooves are flame hardened to min. RC35 for 13mm wire line and larger.

For additional information concerning special AISE sheaves, contact:

**In U.S.A.** - Crosby's Special Engineered Product Group at 1-800-777-1555

**In Canada** - Crosby Canada at (905) 451-9261

**In Europe** - N.V. Crosby Europe at 32-15-757125